

1

2

3

4

5

6

7

A

**NOTES:****1. Material:**

1.1 Housing: LCP+30%GF UL94V-0, Color Black

1.2 Shell: Brass

1.3 Contact :Phosphor Bronze

**2. FINISH:**

2.1 Contact Area: Selective 30u"Au

Solder Area: Tin Plated

Under: Ni Plated

**3. MECHANICAL:**

3.1 Mating Force:3.57kgf Max.

3.2 Unmating Force:1.02kgf Min

3.3 Durability:1500 cycles Min

**4. ELECTRICAL:**

4.1 Current Rating:1.5A

4.2 Dielectric Strength:500V AC FOR 1 MINUTE

4.3 Contact Resistance:30mΩ Max

4.4 Insulation Resistance:1000 MΩ Min

5. Operating temperature: -55°C TO +85°C

② 6. PACKING: Tray

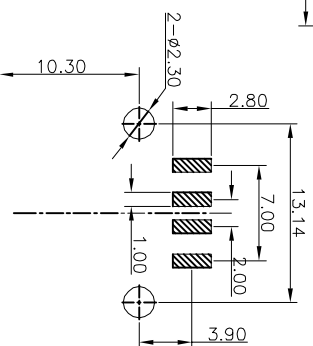
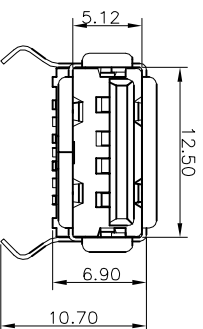
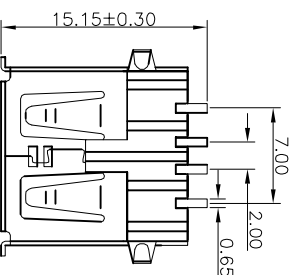
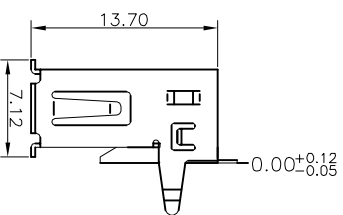
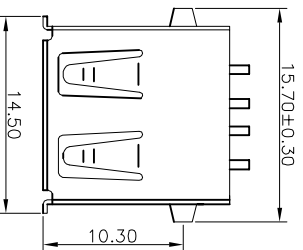
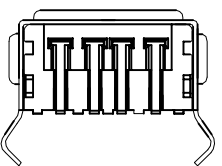

RECOMMENDED P.C.B LAYOUT

A

B

C

D

E

F

G

H

Scale Free

TOLERANCE

.X ±0.30

.XX ±0.20

.XXX ±0.10

DIM TOL

X. ° ±5°

Angle TOL

UNIT mm

Customer-No.

Date	Name
07.06.2013	Winnie
14.07.2014	Winnie

ASSMANN WSW-No.

① AU-Y1006-2

Drawing-No.

ASS 5774 CO rev02

Replace

SHEET

**RoHS compliant**

1

2

3

4

5

6

7

  
 WSW/ components